

CABINET MEMBER FOR ENVIRONMENT – 23 NOVEMBER 2017
PROPOSED TRAFFIC CALMING BUILD-OUT MURCOTT ROAD
ARNCOTT

Report by Director for Infrastructure Delivery

Introduction

1. This report presents responses received in the course of a statutory consultation on a proposal to install a traffic calming build-out on the Murcott Road at Arncott, approximately 20 metres south-west of its junction with The Village Close.

Background

2. Murcott Road which is long and straight with good visibility approaching the village means that traffic has a tendency to exceed the existing speed limit of 30mph as it approaches the residential part of the village. With new development extending the village along the Murcott Road it was felt that some traffic calming measures would be appropriate to extend the already existing series of buildouts. The proposed measure will take the form of a build-out to match the existing traffic calming. A plan showing the location of the proposal is shown at Annex 1.

Consultation

3. Formal consultation on the proposal was carried out between 10 August and 8 September 2017. A public notice was placed in the Bicester Advertiser and sent to statutory consultees, including Thames Valley Police, the Fire & Rescue Service, Ambulance service, Arncott Parish Council and the local County Councillor. Additionally letters were sent to approximately 15 nearby properties.
4. Eight responses were received. These are summarised at Annex 2 with copies available for inspection by County Councillors.
5. Responses comprised four expressions of support, two objections and a further two neither objecting nor supporting (which included the response from Thames Valley Police).
6. The Parish Council unanimously support the proposals. Thames Valley Police did not object but commented that the proposal should help improve safety and be a positive road safety asset.

Responses to objections

7. The two objections received are adjacent to the build-out and are concerned about the increased levels of both noise and air pollution. Whilst their concerns are valid locating the build-out further away from the village would reduce its effectiveness and result in a significant increase in cost, noting it is highly desirable that such build-outs are lit and the proposed location uses existing street lighting. Moving the build-out further away would require a new lighting and electricity supply and funds are limited for this project.

How the Project supports LTP4 Objectives

8. The proposals would help facilitate the safe movement of traffic.

Financial and Staff Implications (including Revenue)

9. Funding for the installation of the traffic calming build-out has been provided by £13,000 of S106 development funds whilst the appraisal of the proposals and consultation has been undertaken by E&E officers as part of their normal duties.

RECOMMENDATION

10. **The Cabinet Member for Environment is RECOMMENDED to approve proposals to install a traffic calming build-out on the Murcott Road at Arccott, approximately 20 metres south-west of its junction with The Village Close as advertised.**

OWEN JENKINS
Director for Infrastructure Delivery

Background papers: Plan of proposed traffic calming build out
 Consultation responses

Contact Officers: Hugh Potter 07766 998704

November 2017

Notes:

- ◆ TMP Bollard with keep right aspect

© Crown Copyright and Database rights 2015 100023343

Rev.	Date	Purpose of revision	Drawn	Checked	Approved

Chris McCarthy
Deputy Director - Commercial
Environment and Economy
Oxfordshire County Council
Speedwell House
Speedwell Street
Oxford
OX1 1NE
Tel: (01865) 815700
Fax: (01865) 241677

Project title
Upper Amcott - Murcott Road

Drawing title
Proposed Build Out

Drawing Status			
Consultation			
Scale @ A3	Drawn by	Checked by	Approved by
n.t.s	RG	MW	MW
	Date drawn June 17	Date checked Julu 17	Date approved July 17

Oxfordshire Project No. & File Ref

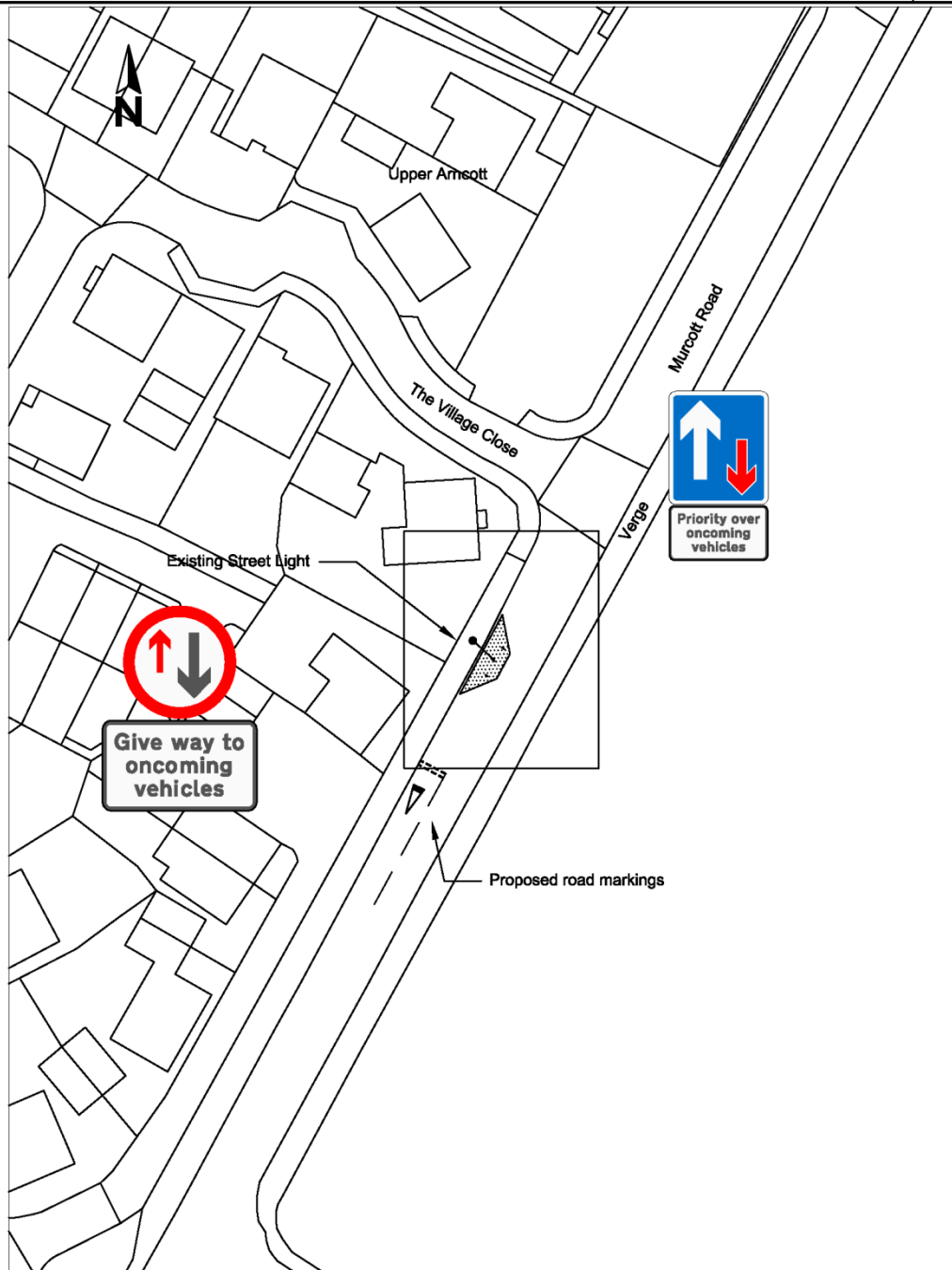
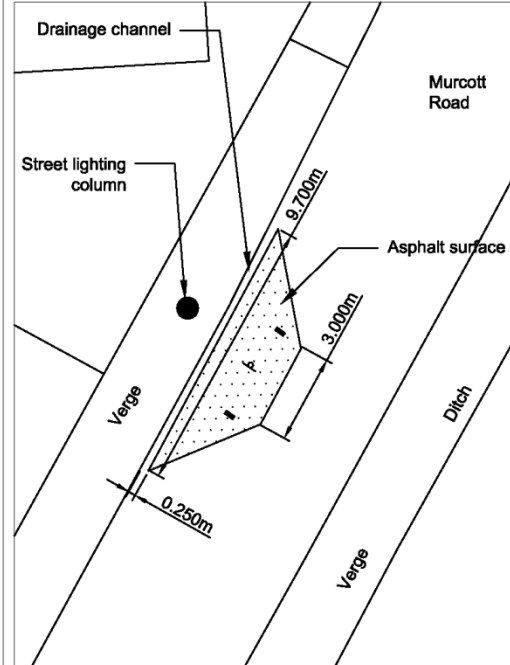

RESPONDENT	SUMMARISED COMMENTS
(1) Thames Valley Police, (Traffic Management Unit)	No objection - The feature is located close to new development where speeds can be higher than the posted limit. Site lines are good which should improve safety and leave the feature as a positive road safety asset.
(2) Arncott Parish Council	Support - Arncott parish Council resolved to support the proposals unanimously.
(3) Local Resident, (The Village Close, Upper Arncott)	<p>Object – The position of the proposed build-out means that we shall now have queuing/waiting traffic outside our front windows, with the associated loss of privacy, noise and pollution as engines are stopped and re-started.</p> <p>A similar build-out at the other end of Arncott village where there are no residential properties has been the site of accidents in the past, and with the proposed position of this build-out so close to residential properties, we are concerned that any accidents could impact on the houses.</p> <p>In our opinion, the build-out should be positioned at the site of the current speed restriction sign, where the houses are set further away from the road and already have a substantial, established hedge. This position is also on the south-western side of Arncott Wood Road, which is the only route into and out of St George’s Barracks.</p> <p>The vast majority of the traffic turning into and out of Arncott Wood Road, which is constant and includes all kinds of military vehicles, heavy lorries and also the S5 Bus, whose terminus is at St George’s Barracks, passes through Arncott village, and would thus have to negotiate the proposed build-out.</p> <p>From time to time, there are double-length low-loader vehicles which already have difficulty negotiating the turning, and a width restriction on their approach from the village would make the manoeuvre even more difficult.</p> <p>As well as the normal and military traffic, the road is a busy route for farm vehicles, which again would be waiting outside our front windows, with the associated noise, pollution and smell, and also the traffic going to and from the Moto Cross Park on practice and race days, all of which would be held at the build-out in front of our house.</p>

CMDE6

	<p>It would make more sense for the traffic approaching the village to be calmed before it reaches Arncott Wood Road allowing easier access to and from the Barracks.</p> <p>We regularly see drivers, some of them travelling at quite a speed, overtaking vehicles which have slowed to turn left into Arncott Wood Road from Murcott Road, and we are amazed that none of these has resulted in a serious accident in the time we have been living here. If the build-out were positioned further out at the restriction sign, then overtaking at this junction would not be an option for the impatient drivers who currently carry out the move.</p> <p>There is no mention in the plan of any approach road markings, such as 'dragons teeth' or 'rumble strips' to indicate the traffic calming feature ahead. Would that be put in place?</p> <p>We are completely in agreement that some form of traffic calming is needed in the vicinity – a build-out would be ideal – but we feel most strongly that the positioning of this would be far better on the other side of the Arncott Wood Road junction, and therefore that the proposal needs to be reviewed.</p>
<p>(4) Local Resident, (Murcott Road, Upper Arncott)</p>	<p>Object – Based on the supplied plans for the construction it looks like it will be placed directly in front of our house meaning that all traffic will be stopping and starting just in front of my daughter bedroom.</p> <p>When we have been in process of buying our house, we have been told that there will be hedge planted up to reduce noise from the traffic all along the road (please see attached) and then when we moved in they all have been taken out. Introducing the proposed traffic calming solution will mean that most of the vehicles will have to stop and start bringing more noise and of course, it will boost the CO2 emission in the area too.</p> <p>We do agree that the traffic in the area need some calming and would happily see some implementation.</p> <p>In our opinion, the traffic calming feature could be built on the entry to the village moving it outside the housing part (please see attached) and then implement kerbed traffic calming feature on the remaining stretch of the road towards Buchanan Road. This would be similar setup as on the entry to the village from the Ambrosden.</p> <p>Please understand that we are not against implementation of traffic calming - it is needed, we would just object to the current proposition.</p>

CMDE6

<p>(5) Local Resident, (The Village Close, Upper Arccott)</p>	<p>Support – It's about time something was done! We have lived here for 4 years and with a park next to the road the speeding cars have been a cause for concern. We walk on the path on Murcott Road and very rarely does anyone slow down coming into the village. Very often cars start to increase their speed past 30mph after the last speed bump before the turn off for Buchan an Road. It's a shame that drivers can't obey the speed limit but fantastic that something has been proposed to tackle the issue. Overwhelming support from out household.</p>
<p>(6) Local Resident, (The Village Close, Upper Arccott)</p>	<p>Support – From my home I see and hear speeding vehicles on a daily basis entering and leaving the village – many often dangerously overtaking in their hurry to leave the village. It is only a matter of time before an accident/fatality occurs given the number of speeding vehicles. Also, as there are many children in the Village Close, many of whom play in the park at the junction, some on bikes – I feel the situation is an accident waiting to happen. I fully support this proposal.</p>
<p>(7) Local Resident, (Norris Road, Arccott)</p>	<p>Support – This should be considered for the other end of Arccott (I.e. Norris Road) where people regularly speed out of the turning past the MOD base</p>
<p>(8) Online response, (unknown)</p>	<p>Neither - With all the extra traffic that is coming through arcott the whole road needs to be looked at for safety I live opposite hopcraft close, it can take me 5 to 10 minutes to get in and of my drive at busy times and with the new business in the close more large lorries parking near the close causing problems for the one way traffic the army presence has increased in the village and extra housing would be good to get it right before extra costs are made.</p>